

Datum Engineering & Surveying LLC.
Richard Zulick
Certified Forester / Soil Scientist
400 Nott Highway
Ashford, CT
06278

May 3, 2022

Town of Somers, CT
Inland Wetlands and Watercourses
Somers, CT

Re: Wetland report for a Proposed Agricultural Clearing
459 Pinney Road, Somers, CT

Dear Commissioners:

I have conducted a wetland delineation to identify the Connecticut regulated wetland soils on the above referenced parcel located east of Pinney Road, Somers, CT. and owned by Wildlife & Forest Management LLC. This delineation was conducted for the purposes of identifying wetland soils as they relate to a proposed clearing.

The wetlands on this plan have been field delineated in accordance with the standards of the National Cooperative Soil Survey and the definition of wetlands as found in the Connecticut General Statutes, Chapter 440, Section 22A-38.

This delineation is not intended to be used for soil mapping but to identify the wetland soils relative to the development and management of this parcel

The wetland boundaries have been marked with pink and blue flagging and labeled as shown on the plan. Flag numbers are WB1 to WB17.

If you have any questions concerning this wetland delineation, please feel free to contact me.

Sincerely,



Richard Zulick
Certified Forester and Soil Scientist
Member SSSSNE

SKETCH NOT TO SCALE

PROPERTY OF:
WILDLIFE & FOREST MANAGEMENT, LLC
459 PINNEY ROAD
SOMERS, CT.

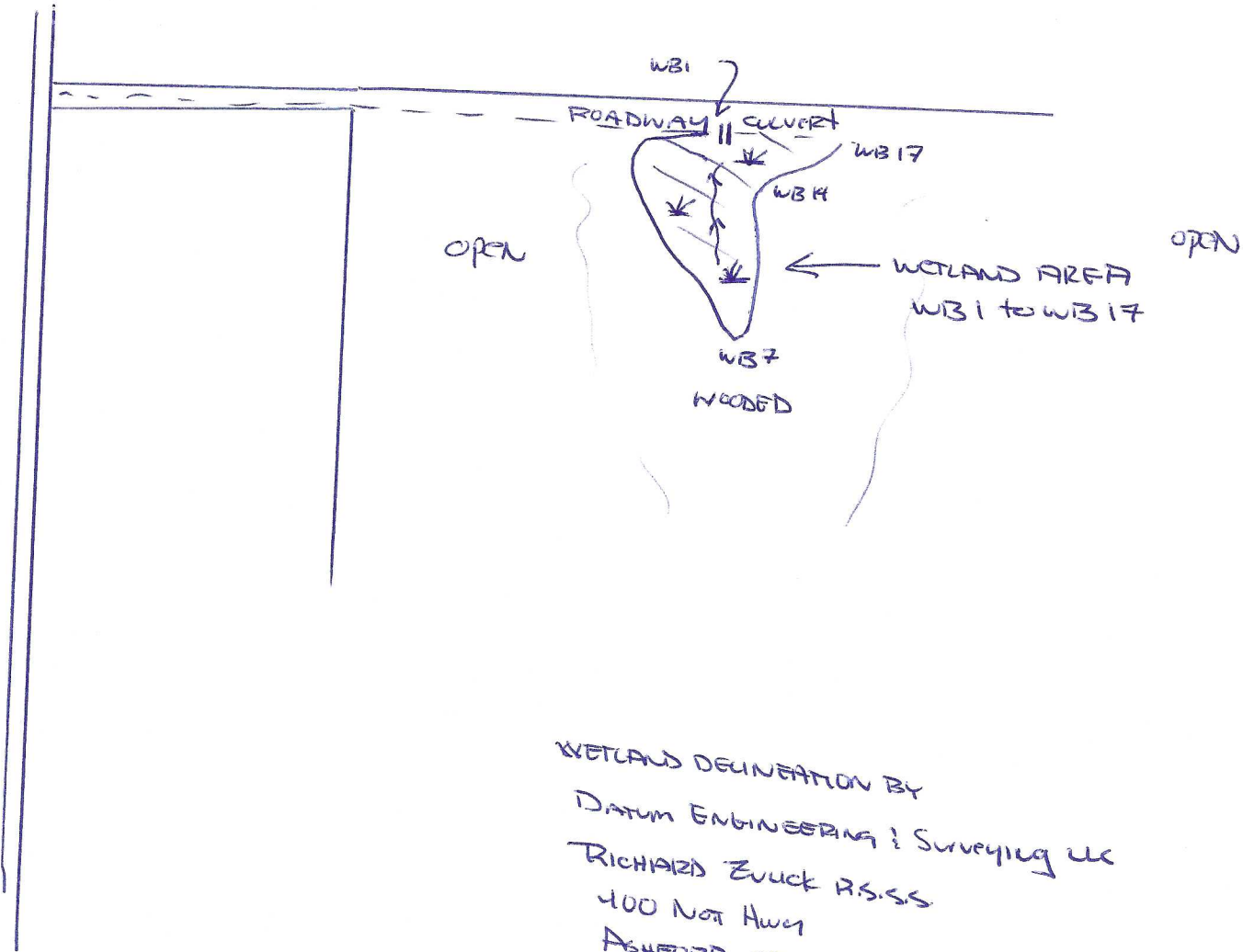

WETLAND DELINEATION BY
DATUM ENGINEERING & SURVEYING LLC
RICHARD ZUCK R.S.S.
400 NOT HWY
ASHFORD, CT 06278
(860) 429-1918

Datum Engineering and Surveying, LLC
Richard Zulick -Consulting Soil Science

400 Nott Highway
Ashford, CT 06278
(860) 429-1918

May 3, 2022

James Wysocki
62 Eaglebrook DRive
Somers, Ct 06071

RE: 459 Pinney Road, Somers, CT

April 2022

Wetland delineation / soil auger testing / Letter

\$ 400.00

Total Due \$ 400.00

**PLEASE MAKE CHECK PAYABLE TO:
Datum Engineering and Surveying LLC.**

Thank You!