



RUSSO

SURVEYORS • ENGINEERS
P.O. BOX 938, EAST WINDSOR, CT 06088

LETTER OF TRANSMITTAL

CT: (860) 623-0569
MA: (413) 785-1158

DATE: 4-27-22	JOB NO. 2021-095
ATTN: Joanna Shapiro	
RE: Jarmoc Farms, Watchaug Road	

TO Town of Somers
Inland Wetlands

WE ARE SENDING YOU Attached Under separate cover Via Deliver, the following items:
 Cover Letter Paper Prints Mylars Specifications Report Other

COPIES	DATE	SHEET NO.	DESCRIPTION
2	4-27-22	1/1	Barn Plot Plan
1	4-28-22	-/3	IWC Application
1	4-20-22	1/1	Zulick Letter
3			PHOTOS

THESE ARE TRANSMITTED (as checked below):

- For approval
- For your use
- For review and comment
- As requested
- For signature
- For your records
- Returned after loan to us
- For bids due _____

REMARKS:

CC: _____

SENT BY: 



Town of Somers Conservation Commission Inland Wetlands & Watercourses Application

Revised Effective 10/7/2020

FOR OFFICE USE ONLY

Application # _____
Date Submitted _____
Fee Collected _____
Date of CC Receipt _____

Property Owner's Information

Name: 520 Hill Hill Rd. LLC
Mailing Address: 520 Hill Hill Rd. Somers, Ct. 06071

WHEN NOT REQUIRED BY LAW TO MAIL NOTICE BY USPS, MAY NOTICES BE EMAILED TO YOU? Yes No
Email: Owen Jarmoc P Jarmoc Farms, LLC Primary Contact Phone #: 860-716-5640

By signing below I certify that all information submitted with this application is true and accurate to the best of my knowledge, that I am aware of and understand the application requirements and regulations, that all work will be completed in accordance with approved plans, and acknowledge that the application is to be considered complete only when all information and documents required by the Commission have been submitted. Moreover, by signing above I/we expressly provide written consent to the filing of the application and access to the site by the Commission and its staff and hired professionals to walk and inspect the property and perform those tests necessary to properly review the application and monitor site work until the permitted activity is completed.

Owner's Signature: [Signature] Date: 04/28/2022

Applicant's Information (if different than owner)

Name: Jarmoc Tobacco, LLC
Mailing Address: 520 Hill Hill Rd. Somers, Ct. 06071

WHEN NOT REQUIRED BY LAW TO MAIL NOTICE BY USPS, MAY NOTICES BE EMAILED TO YOU? Yes No
Email: same Primary Contact Phone #: same

By signing below I certify that all information submitted with this application is true and accurate to the best of my knowledge, that I am aware of and understand the application requirements and regulations, that all work will be completed in accordance with approved plans, and acknowledge that the application is to be considered complete only when all information and documents required by the Commission have been submitted.

Applicant's Signature: [Signature] Date: 04/28/2022

Property Information

Street Address: 520 Hill Hill Rd Size of Property (acres): 50.59
Total area of wetlands/watercourses on parcel in square feet or acres: 1990. From GIS
Proposed disturbance or alteration to wetlands/watercourses (square feet & linear feet.): NONE
Proposed disturbance within Upland Review Area (square feet, within 100' of wetland or watercourse): _____
Proposed area of wetlands/watercourses to be restored, enhanced, or created (square feet or acres): NONE

Is the property served by: **Public Water:** Yes No* **Public Sewer:** Yes No*
**If not served by public water and/or sewer, applicant shall make application to Somers Health Department if required.*
Is there a Conservation Restriction or Preservation Restriction on the property? Yes* No **If Yes, please attach evidence that adequate notice was provided to holder of restriction or letter from holder verifying that application is in compliance (CGS 47-42a,b,c)*

Application Information – Please refer to § 211-19 for Application Fee schedule, in addition to state land use fee.

Type of Project: (check one)
 Residential Commercial/Industrial Mixed Use Forestry Agricultural Other: _____
Type of Application: (check one)
 Wetland Permit Minimal Impact Permit¹ Jurisdictional Ruling² Permit Modification³ Permit Extension³

¹Limited to appurtenant, at-grade structures <500 square feet and ≥25 feet from wetland/watercourse. See § 211-12 for more information.
²See § 211-4 for details regarding permitted uses as of right and nonregulated uses. Sufficient info must be provided for the Commission to make a ruling.
³Existing permit must be valid for ≥65 days after the date submitted. See § 211-71 for further instructions.

Project Narrative *Please attach reports and supporting documentation as necessary.* Additional Info Attached? Yes No

1. Describe the nature and purpose of proposed regulated activity, request for acceptance of a permitted use as of right or a nonregulated use, map or regulation amendment, or other activity requiring review by the Commission or its Agent:

Application for an agricultural jurisdictional ruling involving the construction of tobacco barns. Barns to be located within an upland area.

2. Describe how the proposed activity affects wetlands, watercourses, and the regulated areas. Describe the nature of the affected resources, including their function, and list any wetlands of special interest (vernal pool, marsh, bog, etc.) :

N/A

3. Describe measures that will be taken to minimize the impact on wetlands, watercourses and the regulated areas, including proposed erosion and sedimentation controls and other management practices or mitigation measures:

Wood chip berms are in place adjacent to the intermittent watercourse.

4. Describe alternatives considered and why activity proposed in application was chosen as preferred alternative:

N/A

Applicant shall provide certification in accordance with Inland Wetlands and Watercourses Regulations, § 211-7G:

- Whether or not any portion of the property on which the regulated activity is proposed is located within 500 feet of an adjoining town. Yes No
- Whether or not a significant portion of the traffic to the completed project will use streets within an adjoining town to exit or enter the site. Yes No
- Whether or not a significant portion of the sewer or water drainage from the project will flow through and significantly impact the sewer or water drainage system of an adjoining town. Yes No
- Whether water run-off from the improved site will impact streets or other municipal/private property within an adjoining town. Yes No

FOR OFFICE USE ONLY

If YES to any of the above, the Commission shall, in accordance with CGS 8-7d(f) and IWWR 211-8C, notify the clerk of any adjoining municipality of the pendency of any application, petition, appeal, request or plan concerning any project on any site. Notice of the pendency of such application shall be made by certified mail, return receipt requested, and shall be mailed within seven (7) days of the date of receipt of the application, petition, appeal, request or plan. (See § 211-8C)

Is any portion of wetland/watercourse within 500' of the boundary of another municipality? Yes* No

*If yes, the applicant shall give written notice of application by certified mail, return receipt requested, on the same day to the Inland Wetlands Commission of other municipality. Proof must be provided to Wetland Agent. See § 211-8

Site Plan Requirements (See § 211-7E) – 2 hard copies and an electronic copy required with application

- Scale of 1" = 20' to 1" = 100', or other scale as appropriate considering the proposal
- Show the proposed activity and existing and proposed conditions in relation to wetlands and watercourses and Upland Review Area.
- For Wetland Permit – field-delineated wetland boundaries with wetland flag numbers/locations and soil scientist's signature on plan.
- Clearing limits/limit of disturbance, property lines, existing and proposed topography, proposed drainage, proposed erosion controls.
- Identify any further activities associated with, or reasonably related to, the proposed regulated activity which are made inevitable by the proposed regulated activity and which may have an impact on wetlands or watercourses.
- Diagram of alternatives considered by the applicant

PLEASE NOTE: If the Conservation Commission determines, based upon its review of the initial submittal, that either the proposed activity involves a significant activity, or additional technical or other information is necessary in order to properly and fully evaluate the proposed activity, any or all of the additional information listed in § 211-7F of the IWWA Regulations may be required in addition to this application and general site plan requirements. The Commission may additionally determine that the application warrants a complex application fee to be paid by the applicant to allow review by third party expert(s) with the appropriate expertise, pursuant to Town Ordinance (see § 114-7, 8, 9, 10).

Statewide Inland Wetlands & Watercourses Activity Reporting Form

Please complete this form in accordance with the instructions on pages 2 and 3 and mail to:

DEEP Land & Water Resources Division, Inland Wetlands Management Program, 79 Elm Street, 3rd Floor, Hartford, CT 06106

Incomplete or incomprehensible forms will be mailed back to the inland wetlands agency.

PART I: Must Be Completed By The Inland Wetlands Agency

- DATE ACTION WAS TAKEN: year: _____ month: _____
- ACTION TAKEN (see instructions - one code only): _____
- WAS A PUBLIC HEARING HELD (check one)? yes no
- NAME OF AGENCY OFFICIAL VERIFYING AND COMPLETING THIS FORM:
(print name) _____ (signature) _____

PART II: To Be Completed By The Inland Wetlands Agency Or The Applicant

- TOWN IN WHICH THE ACTIVITY IS OCCURRING (print name): SOMERS
does this project cross municipal boundaries (check one)? yes no
if yes, list the other town(s) in which the activity is occurring (print name(s)): _____
- LOCATION (see instructions for information): USGS quad name: Hamden Ma. - Conn. or number: 9
subregional drainage basin number: 4201
- NAME OF APPLICANT, VIOLATOR OR PETITIONER (print name): Jarmoc Tobacco, LLC
- NAME & ADDRESS OF ACTIVITY / PROJECT SITE (print information): 520 Hill Hill Rd
briefly describe the action/project/activity (check and print information): temporary permanent description: CONSTRUCTION OF SIX TOBACCO BARNs.
- ACTIVITY PURPOSE CODE (see instructions - one code only): G
- ACTIVITY TYPE CODE(S) (see instructions for codes): 12, 14, _____, _____
- WETLAND / WATERCOURSE AREA ALTERED (see instructions for explanation, must provide acres or linear feet):
wetlands: 0 acres open water body: 0 acres stream: 0 linear feet
- UPLAND AREA ALTERED (must provide acres): 4.74 acres
- AREA OF WETLANDS / WATERCOURSES RESTORED, ENHANCED OR CREATED (must provide acres): 0 acres

DATE RECEIVED:

PART III: To Be Completed By The DEEP

DATE RETURNED TO DEEP:

FORM COMPLETED: YES NO

FORM CORRECTED / COMPLETED: YES NO

Datum Engineering & Surveying LLC.
Richard Zulick
Certified Forester / Soil Scientist
400 Nott Highway
Ashford, CT
06278

April 20, 2022

JR Russo & Associates LLC
1 Shoham Rd
East Windsor, CT

Re: Wetland delineation 520 Hall Hill Road, Watchaug Road, Somers, CT - Jarmoc Farms
JR Russo plan dated 3/11/22 - job number 2021-095 - revised 4/19/22

To Whom it may concern:

On April 14, 2022, I conducted a wetland delineation to identify the Connecticut regulated wetland soils on the above referenced parcel located at 520 Hall Hill Road, in the Town of Somers, CT. This delineation was conducted for the purposes of identifying wetland soils associated with the development of proposed barns as depicted on the above referenced Barn Plot Plan. The limits of flagging consisted of only the regulated soils and watercourses adjacent to the proposed building.

To the north of the proposed barns is a watercourse flagged as CWC (center of Watercourse) A1 to CWC A4 where the flow dissipates into the ground and , therefore, ends.

To the west the flags are labeled WB1 to WB11 delineating Raypol wetland soils. The Raypol series consists of very deep, poorly drained soils formed in loamy over sandy and gravelly outwash.

TAXONOMIC CLASS: Coarse-loamy over sandy or sandy-skeletal, mixed, active, acid, mesic Aeric Endoaquepts

To the south of the proposed barns a watercourse is identified as CWC1 to CWC3 by flagging and said watercourse continues easterly as shown on plan.

The inspection for wetlands soils was flagged in accordance with the standards of the National Cooperative Soil Survey and the definition of wetlands as found in the Connecticut General Statutes, Chapter 440, Section 22A-38. All flagging was fluorescent pink and blue and numbered as shown on the plan.

If you have any questions concerning this report, please feel free to contact me

Sincerely,

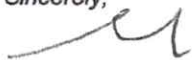

Richard Zulick
Certified Forester and Soil Scientist
Member SSSSNE

22-008



LESICO



Quality Select
Premium Turf Seed

- LESICO Landscape Quality
- Rich Green Color
- High Germination Rate
- Exclusive SiteOne Product

LESICO.COM | 800.748.3663

NET WT. 50 LB. (22.7 KG.)

Quality Select Seed

Quality Select Seed

Quality Select Seed

LESICO

North Side Ditch

Wood chip Berm

End of North
IWC PER R. Zwick

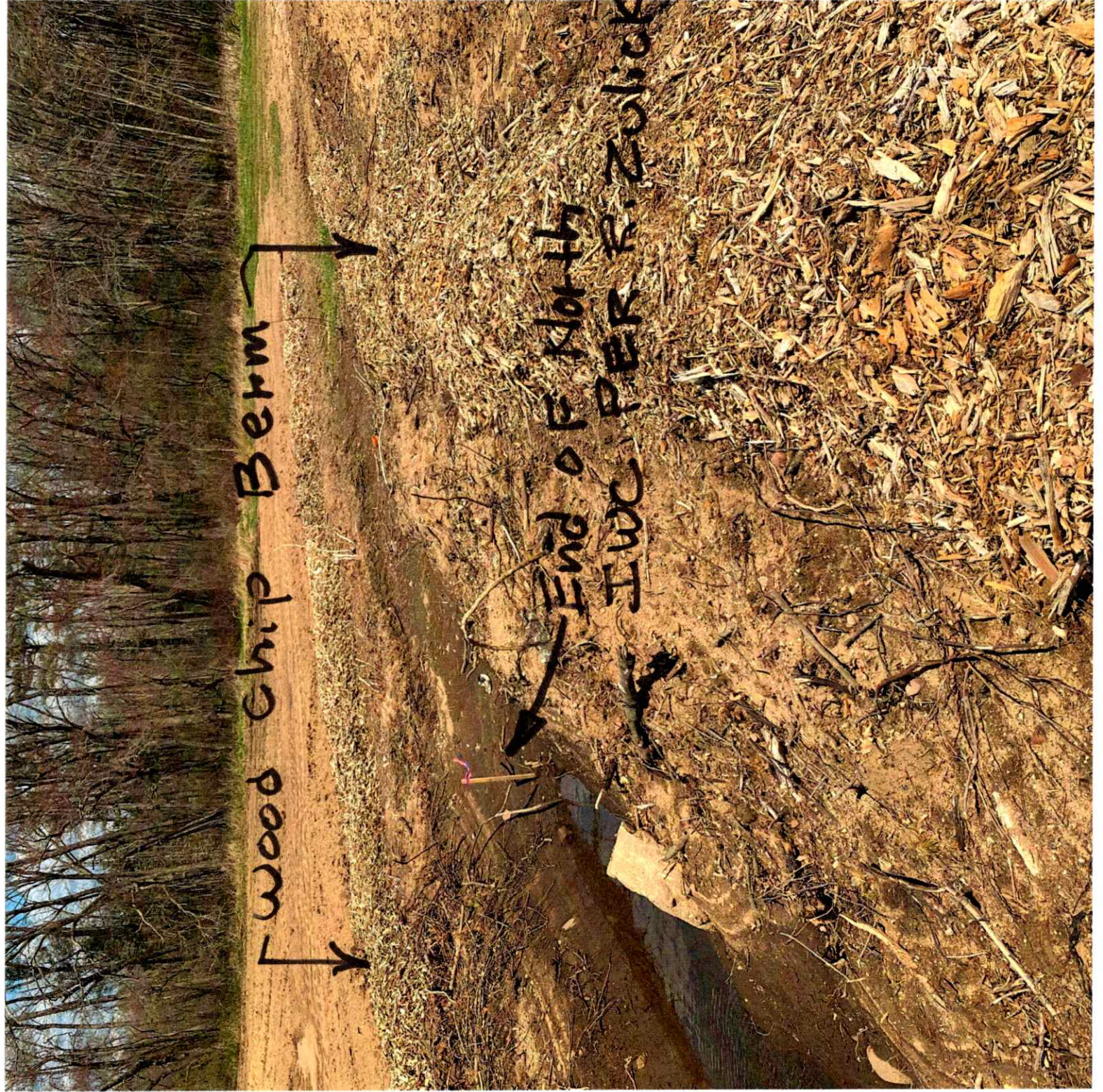

North



Side Ditch



Wood Chip Berms

South Side
Ditch

Wood
chip
Berm

