



LETTER OF TRANSMITTAL

DATE: 10/4/21	JOB NO. 2007-081
ATTN: Joanna Shapiro	
RE: Sonny's Place 349 Main Street Somers, CT	

TO Somers Conservation Commission  
 \_\_\_\_\_  
 \_\_\_\_\_

WE ARE SENDING YOU  Attached  Under separate cover Via Delivery, the following items:  
 Cover Letter  Paper Prints  Mylars  Specifications  Report  Other

COPIES	DATE	SHEET NO.	DESCRIPTION
2	9/29/21	-/9	Site Plan - Bumper Boats & Mini Golf Expansion
1	9/30/21		Inland Wetlands + Watercourses Application
1	9/30/21		Water Quality Basin Sizing Calculations

THESE ARE TRANSMITTED (as checked below):

- For approval    For your use    For review and comment    As requested  
 For signature    For your records    Returned after loan to us    For bids due \_\_\_\_\_

REMARKS:

CC: \_\_\_\_\_

SENT BY: Tim Coon



# Town of Somers Conservation Commission Inland Wetlands & Watercourses Application

Revised Effective 10/7/2020

**FOR OFFICE USE ONLY**

Application # \_\_\_\_\_  
Date Submitted \_\_\_\_\_  
Fee Collected \_\_\_\_\_  
Date of CC Receipt \_\_\_\_\_

**Property Owner's Information**

Name: Driving Range 349 Main Street LLC  
Mailing Address: 15 Mullen Road, Enfield, CT 06082

WHEN NOT REQUIRED BY LAW TO MAIL NOTICE BY USPS, MAY NOTICES BE EMAILED TO YOU?  Yes  No

Email: jonathane@usa-recycle.com Primary Contact Phone #: 860-808-6047  
toon@jirfusso.com

*By signing below I certify that all information submitted with this application is true and accurate to the best of my knowledge, that I am aware of and understand the application requirements and regulations, that all work will be completed in accordance with approved plans, and acknowledge that the application is to be considered complete only when all information and documents required by the Commission have been submitted. Moreover, by signing above I/we expressly provide written consent to the filing of the application and access to the site by the Commission and its staff and hired professionals to walk and inspect the property and perform those tests necessary to properly review the application and monitor site work until the permitted activity is completed.*

Owner's Signature: \_\_\_\_\_ Date: 9/30/21

**Applicant's Information (if different than owner)**

Name: same as owner  
Mailing Address: \_\_\_\_\_

WHEN NOT REQUIRED BY LAW TO MAIL NOTICE BY USPS, MAY NOTICES BE EMAILED TO YOU?  Yes  No

Email: \_\_\_\_\_ Primary Contact Phone #: \_\_\_\_\_

*By signing below I certify that all information submitted with this application is true and accurate to the best of my knowledge, that I am aware of and understand the application requirements and regulations, that all work will be completed in accordance with approved plans, and acknowledge that the application is to be considered complete only when all information and documents required by the Commission have been submitted.*

Applicant's Signature: \_\_\_\_\_ Date: 9/30/21

**Property Information**

Street Address: 349 Main Street Size of Property (acres): 25  
Total area of wetlands/watercourses on parcel in square feet or acres: 6± acres  
Proposed disturbance or alteration to wetlands/watercourses (square feet & linear feet.): 36 SF  
Proposed disturbance within Upland Review Area (square feet, within 100' of wetland or watercourse): 24,760 SF  
Proposed area of wetlands/watercourses to be restored, enhanced, or created (square feet or acres): 0

Is the property served by: **Public Water:**  Yes  No\* **Public Sewer:**  Yes  No\*

*\*If not served by public water and/or sewer, applicant shall make application to Somers Health Department if required.*

Is there a Conservation Restriction or Preservation Restriction on the property?  Yes\*  No *\*If Yes, please attach evidence that adequate notice was provided to holder of restriction or letter from holder verifying that application is in compliance (CGS 47-42a,b,c)*

**Application Information – Please refer to § 211-19 for Application Fee schedule, in addition to state land use fee.**

**Type of Project: (check one)**  
 Residential  Commercial/Industrial  Mixed Use  Forestry  Agricultural  Other: \_\_\_\_\_

**Type of Application: (check one)**  
 Wetland Permit  Minimal Impact Permit<sup>1</sup>  Jurisdictional Ruling<sup>2</sup>  Permit Modification<sup>3</sup>  Permit Extension<sup>3</sup>

<sup>1</sup>Limited to appurtenant, at-grade structures <500 square feet and ≥25 feet from wetland/watercourse. See § 211-12 for more information.  
<sup>2</sup>See § 211-4 for details regarding permitted uses as of right and nonregulated uses. Sufficient info must be provided for the Commission to make a ruling.  
<sup>3</sup>Existing permit must be valid for ≥65 days after the date submitted. See § 211-71 for further instructions.

**Project Narrative** *Please attach reports and supporting documentation as necessary.* Additional Info Attached?  Yes  No

1. Describe the nature and purpose of proposed regulated activity, request for acceptance of a permitted use as of right or a nonregulated use, map or regulation amendment, or other activity requiring review by the Commission or its Agent:

Regulated activity includes a parking lot expansion and drainage improvements associated with addition of an 18-hole mini-golf course and bumper boats.

2. Describe how the proposed activity affects wetlands, watercourses, and the regulated areas. Describe the nature of the affected resources, including their function, and list any wetlands of special interest (vernal pool, marsh, bog, etc.):

Permanent wetland impact is limited to the construction of a riprap apron at the edge of the man-made wetland. Disturbance is limited to 36 SF.

3. Describe measures that will be taken to minimize the impact on wetlands, watercourses and the regulated areas, including proposed erosion and sedimentation controls and other management practices or mitigation measures:

E+5 controls will include installation of perimeter sediment barriers, a construction entrance, isolated topsoil stockpiles and inlet protection at structures as they are installed. Disturbed areas are to be seeded as soon as feasible.

4. Describe alternatives considered and why activity proposed in application was chosen as preferred alternative:

The alternative to the drainage outfall in the wetland at the toe of slope would be to install it further up the slope. Discharge onto the slope would be undesirable and create the potential for erosion of the slope.

**Applicant shall provide certification in accordance with Inland Wetlands and Watercourses Regulations, § 211-7G:**

- Whether or not any portion of the property on which the regulated activity is proposed is located within 500 feet of an adjoining town.  Yes  No
- Whether or not a significant portion of the traffic to the completed project will use streets within an adjoining town to exit or enter the site.  Yes  No
- Whether or not a significant portion of the sewer or water drainage from the project will flow through and significantly impact the sewer or water drainage system of an adjoining town.  Yes  No
- Whether water run-off from the improved site will impact streets or other municipal/private property within an adjoining town.  Yes  No

**FOR OFFICE USE ONLY**

If YES to any of the above, the Commission shall, in accordance with CGS 8-7d(f) and IWWR 211-8C, notify the clerk of any adjoining municipality of the pendency of any application, petition, appeal, request or plan concerning any project on any site. Notice of the pendency of such application shall be made by certified mail, return receipt requested, and shall be mailed within seven (7) days of the date of receipt of the application, petition, appeal, request or plan. (See § 211-8C)

Is any portion of wetland/watercourse within 500' of the boundary of another municipality?  Yes\*  No

\*If yes, the applicant shall give written notice of application by certified mail, return receipt requested, on the same day to the Inland Wetlands Commission of other municipality. Proof must be provided to Wetland Agent. See § 211-8

**Site Plan Requirements (See § 211-7E) – 2 hard copies and an electronic copy required with application**

- Scale of 1" = 20' to 1" = 100', or other scale as appropriate considering the proposal
- Show the proposed activity and existing and proposed conditions in relation to wetlands and watercourses and Upland Review Area.
- For Wetland Permit – field-delineated wetland boundaries with wetland flag numbers/locations and soil scientist's signature on plan.
- Clearing limits/limit of disturbance, property lines, existing and proposed topography, proposed drainage, proposed erosion controls.
- Identify any further activities associated with, or reasonably related to, the proposed regulated activity which are made inevitable by the proposed regulated activity and which may have an impact on wetlands or watercourses.
- Diagram of alternatives considered by the applicant

**PLEASE NOTE:** If the Conservation Commission determines, based upon its review of the initial submittal, that either the proposed activity involves a significant activity, or additional technical or other information is necessary in order to properly and fully evaluate the proposed activity, any or all of the additional information listed in § 211-7F of the IWWA Regulations may be required in addition to this application and general site plan requirements. The Commission may additionally determine that the application warrants a complex application fee to be paid by the applicant to allow review by third party expert(s) with the appropriate expertise, pursuant to Town Ordinance (see § 114-7, 8, 9, 10).



CONNECTICUT DEPARTMENT OF ENVIRONMENTAL PROTECTION  
79 Elm Street  
Hartford, CT 06106-5127

GIS CODE #:  
For DEP Use Only

Arthur J. Rocque, Jr., Commissioner

## Statewide Inland Wetlands & Watercourses Activity Reporting Form

Please complete this form in accordance with the instructions. Please print or type.

### PART I: To Be Completed By The Inland Wetlands Agency Only

- DATE ACTION WAS TAKEN: Year \_\_\_\_\_ Month \_\_\_\_\_
- ACTION TAKEN: \_\_\_\_\_
- WAS A PUBLIC HEARING HELD? Yes \_\_\_\_\_ No \_\_\_\_\_
- NAME OF AGENCY OFFICIAL VERIFYING AND COMPLETING THIS FORM:  
(print) \_\_\_\_\_ (signature) \_\_\_\_\_

### PART II: To Be Completed By The Inland Wetlands Agency Or The Applicant

- TOWN IN WHICH THE ACTION IS OCCURRING: Somers  
Does this project cross municipal boundaries? Yes \_\_\_\_\_ No X  
If Yes, list the other town(s) in which the action is occurring: \_\_\_\_\_
- LOCATION: USGS Quad Map Name: Ellington AND Quad Number: 24  
Subregional Drainage Basin Number: 4200
- NAME OF APPLICANT, VIOLATOR OR PETITIONER: Driving Range 349 Main Street LLC
- NAME & ADDRESS/LOCATION OF PROJECT SITE: 349 Main St  
Briefly describe the action/project/activity: Parking expansion + drainage improvements
- ACTIVITY PURPOSE CODE: D
- ACTIVITY TYPE CODE(S): 10, 12, 14, \_\_\_\_\_
- WETLAND / WATERCOURSE AREA ALTERED [must be provided in acres or linear feet as indicated]:  
Wetlands: 0.0008 acres Open Water Body: 0 acres Stream: 0 linear feet
- UPLAND AREA ALTERED [must be provided in acres as indicated]: 0.56± acres
- AREA OF WETLANDS AND / OR WATERCOURSES RESTORED, ENHANCED OR CREATED: 0 acres  
[must be provided in acres as indicated]

DATE RECEIVED:

**PART III: To Be Completed By The DEP**

DATE RETURNED TO DEP:

FORM COMPLETED: YES NO

FORM CORRECTED / COMPLETED: YES NO

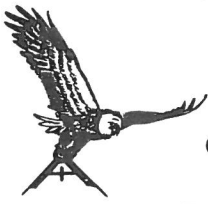

## WATER QUALITY BASIN SIZING

### ① Water Quality Volume (WQV)

$$WQV = (I'')(R)(A) / 12 \quad \text{where:}$$

WQV = water quality volume (ac-ft)

R = runoff coeff.

A = contributing area (acres)

I = percent impervious

$$R = 0.05 + 0.009 I$$

$$A = 42,194 \text{ SF} = 0.97 \text{ ac}$$

$$I = [(21,742 \text{ SF}) / (42,194)] \times 100 = 51.5\%$$

$$R = 0.05 + 0.009 (51.5) = 0.514$$

$$\begin{aligned} WQV &= (1'')(0.514)(0.97 \text{ ac}) / 12 \\ &= 0.0415 \text{ ac-ft} \\ &= 1809 \text{ CF} \end{aligned}$$

### ② Volume Provided

Elev.	Area (SF)	Inc. Vol (CF)	Cum. Vol (CF)
190.5	1056 SF	0	0
192.5	2535 SF	3591	3591

# DRAINAGE AREA MAP

1"=50'

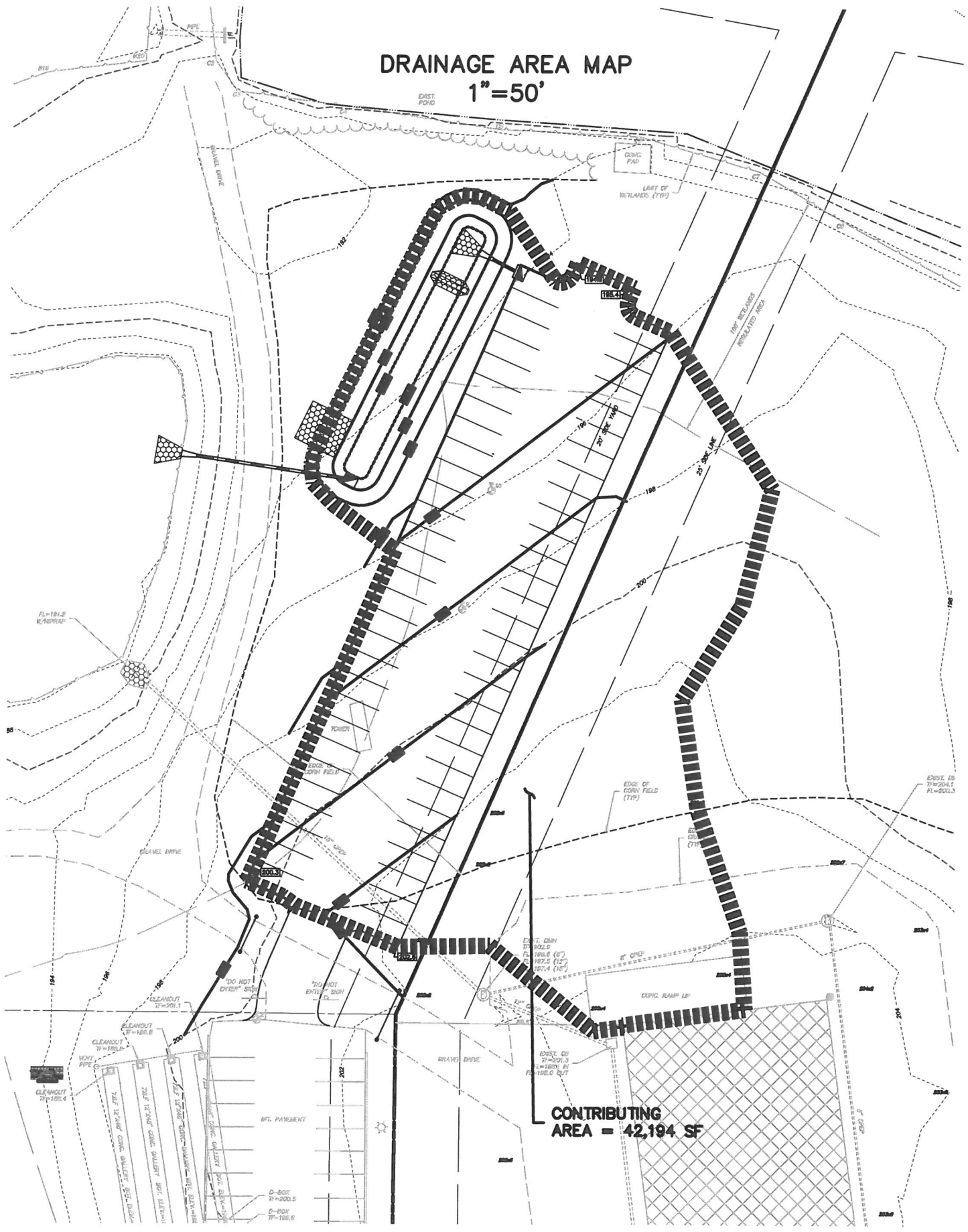

**CONTRIBUTING  
AREA = 42,194 SF**